

iPhone

AvosetGO Instructions

Setting up the app – first time use only

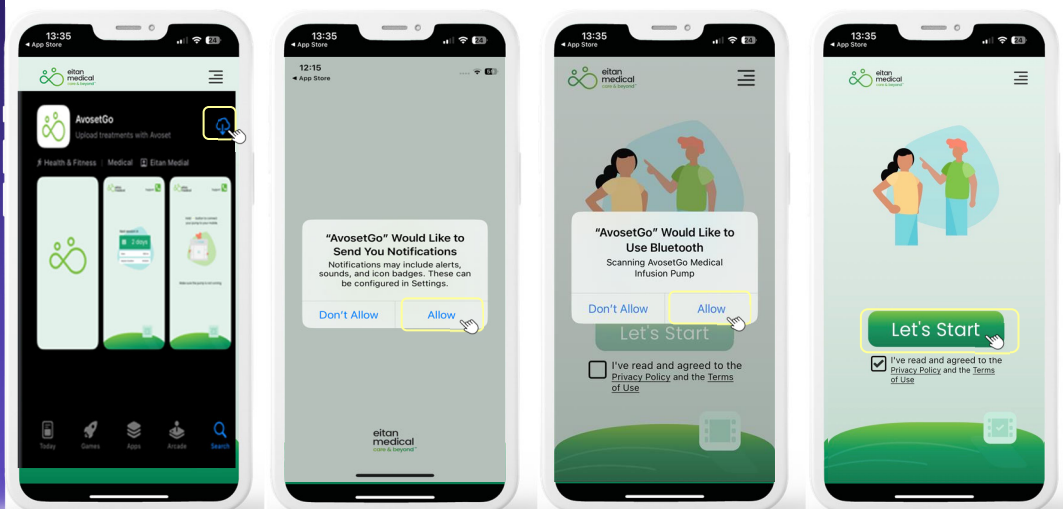

Download the AvosetGo App.

Allow the app to send notifications

Allow the app to use Bluetooth

Approve the privacy policy and terms of use by checking the box, and press **Let's Start**

Pairing your pump to the app

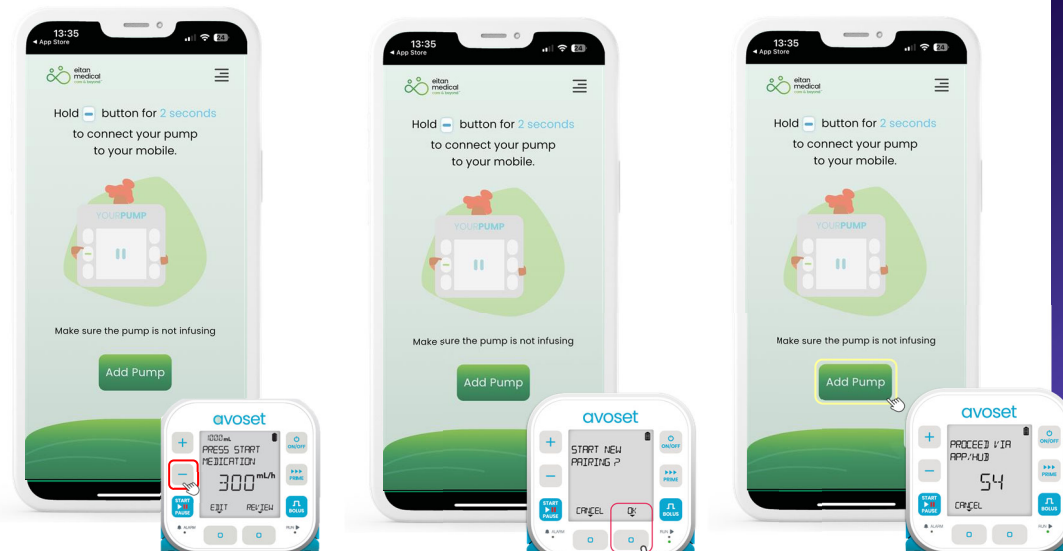

Turn your pump ON. From the home screen, Press and hold the (-) button to begin the pairing process.

Press OK on the pump to start the pairing.

Press Add Pump

Pairing your pump to the app

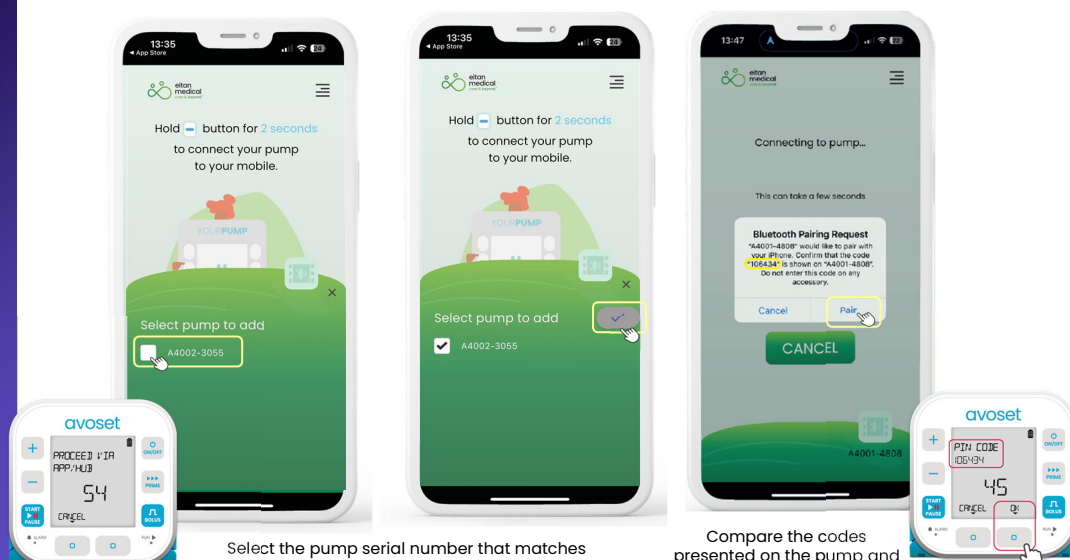

Select the pump serial number that matches your pump and select the gray check box.

Compare the codes presented on the pump and on the app to make sure they match and press **Pair** and **OK**

Data transfer with the app

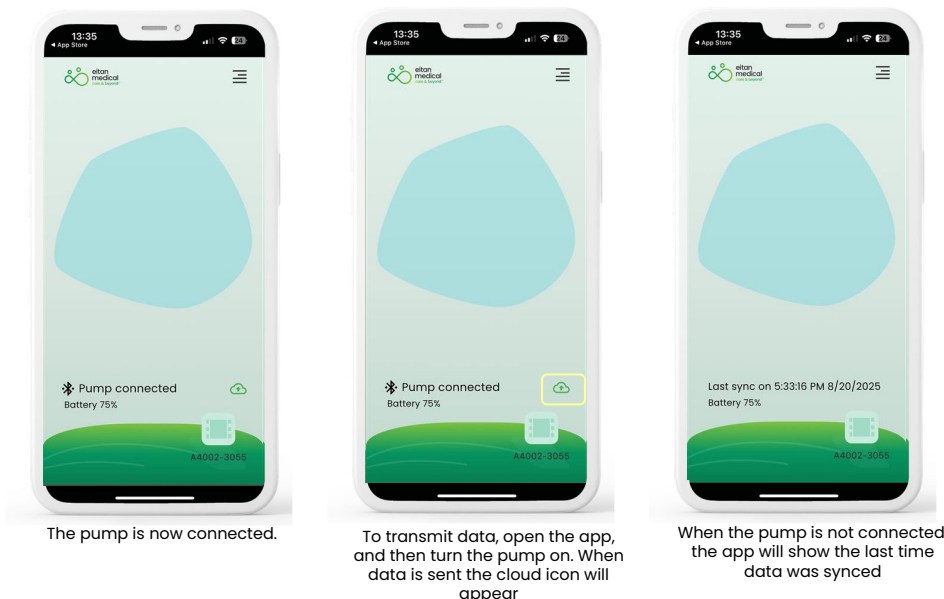

Please call 1-800-755-4704 if you have any questions or concerns at all while using the AvosetGo application with your Eitan Medical Avoset pump.

We are available 24 hours a day, 7 days a week. In the event of an emergency, always call 911.

Android

AvosetGo Instructions

Setting up the app – first time use only



Setting up the app – first time use only

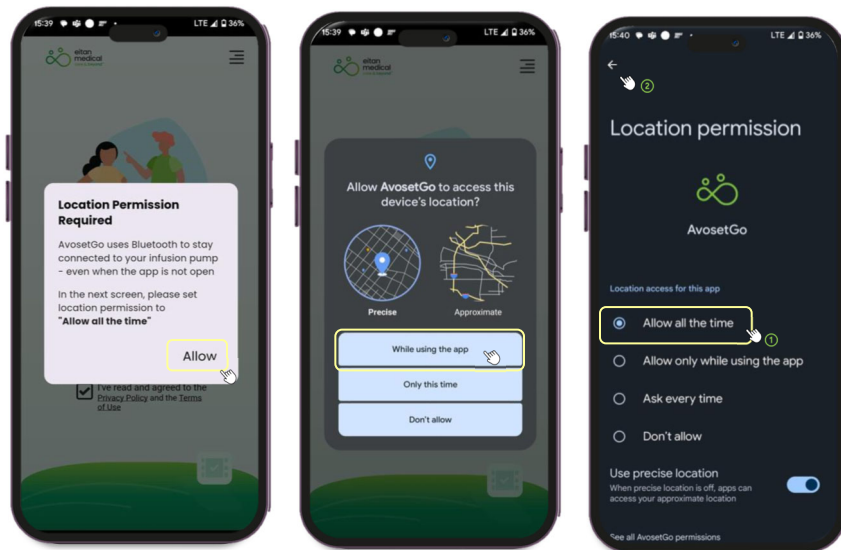

Setting up the app – first time use only

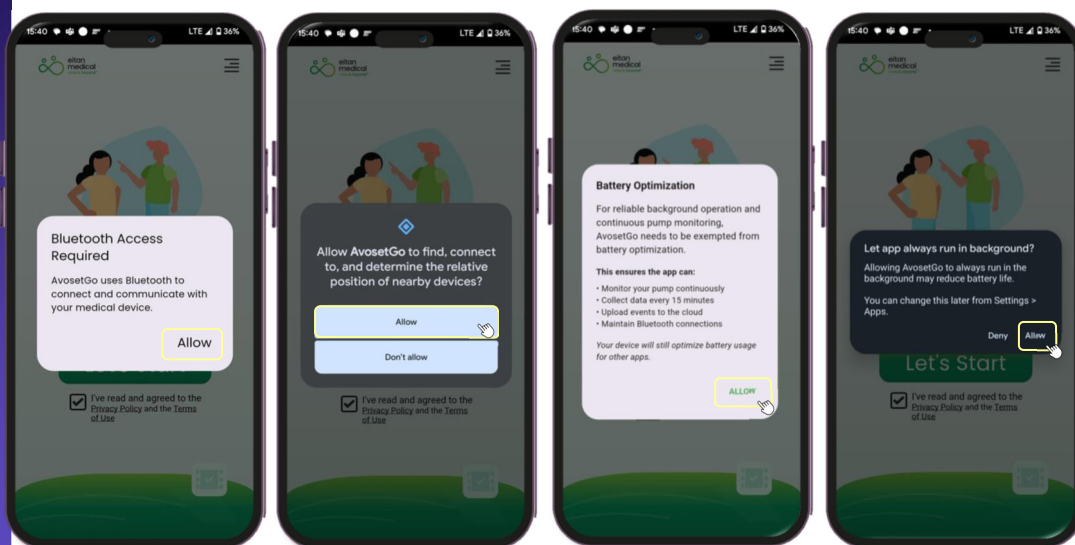

Pairing your pump to the app

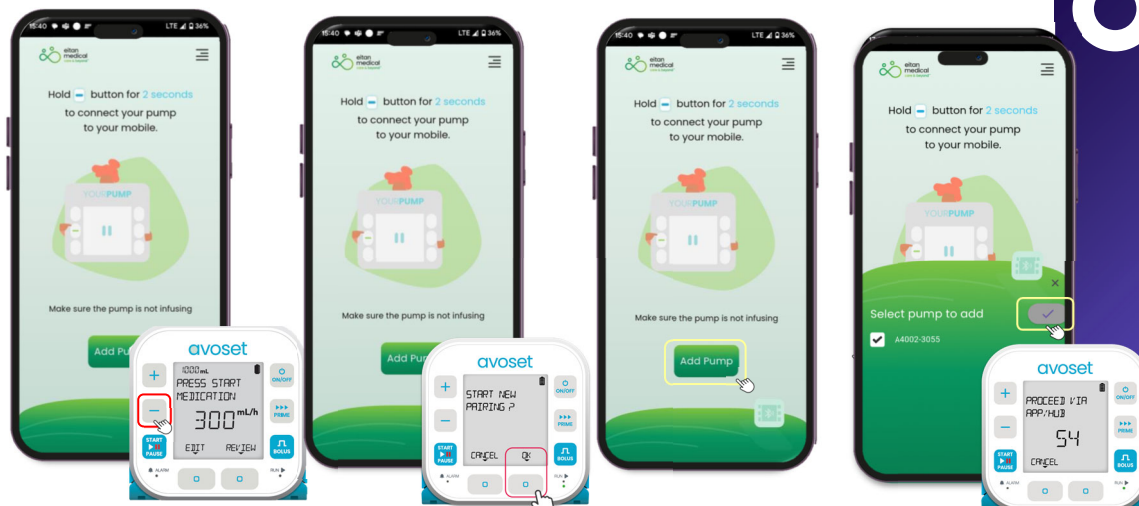

Make sure your pump is turned ON. From the home screen, Press and hold the (-) button to begin the pairing process.

Press OK on the pump to start the pairing.

Press Add Pump

Select the pump serial number that matches your pump and select the gray check box.

Pairing your pump to the app

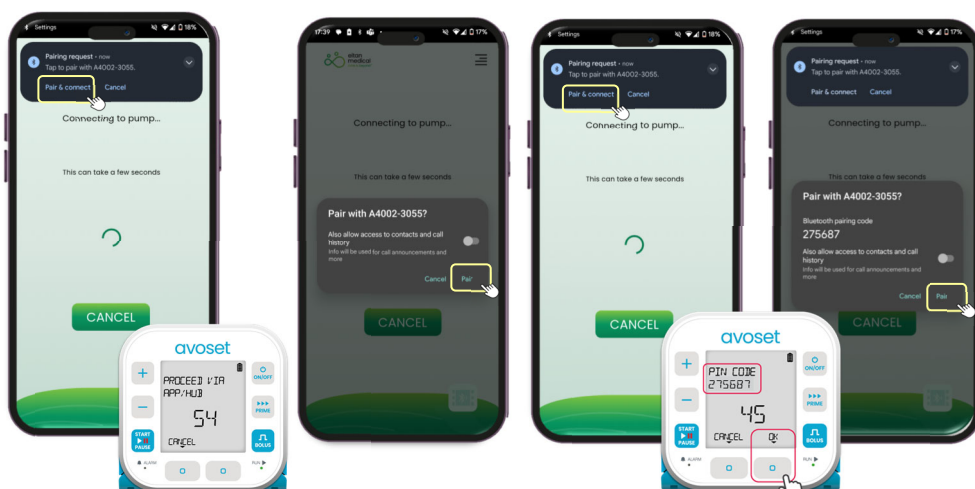

Click **Pair & Connect**

Click **Pair**

Click **Pair & Connect**

Compare the codes presented on the pump and on the app to make sure they match, and press **Pair** and **OK**

Data transfer with the app

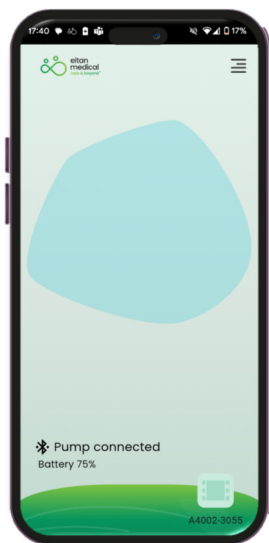

The pump is now connected.

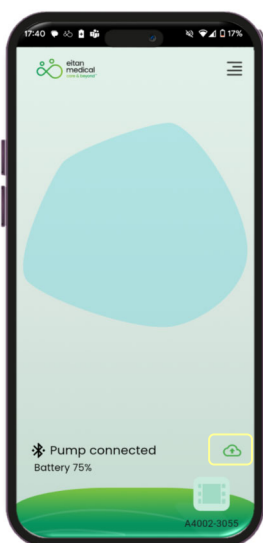

The pump will operate in the background and send data from your pump periodically when the infusion is running. When data is sent the cloud icon will appear.

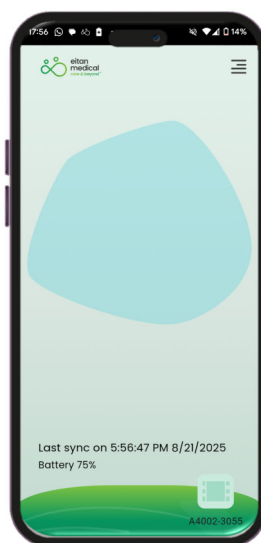

When the pump is not connected, the app will show the last time data was synced.



Please call 1-800-755-4704 if you have any questions or concerns at all while using the AvosetGo application with your Eitan Medical Avoset pump.

We are available 24 hours a day, 7 days a week. In the event of an emergency, always call 911.